

ACADEMIC AND BELLEVUE CAMPUSES

CENTRAL

- C002 EARTH SCIENCES
- C004 ELECTRON MICROSCOPE UNIT
- C006 ARTS EDUCATION
- C008 MADGWICK HALL
- C012 INSTITUTE FOR RURAL FUTURES
- C013 THE PATRICIA O'SHANE BUILDING - RURAL MEDICAL SCHOOL
- C014 ARTS EDUCATION ANNEXE
- C015 UNION COMPLEX - WESTON COMMON ROOM
- C016 UNION COMPLEX - LAZENBY HALL
- C017 UNION COMPLEX - SHOPS (BELSHAW WING)
- C018 UNION COMPLEX - BISTRO AREA
- C019 YARM GWANGA - CHILD CARE CENTRE
- C021 CENTRE FOR WATER POLICY
- C022 LIQUID NITROGEN STORE - CHEMISTRY
- C023 RIGGS BUILDING
- C024 STOKES BUILDING
- C026 MATHEMATICS, STATISTICS & COMPUTER SCIENCE
- C027 BOOTH BLOCK
- C028 LEWIS LECTURE THEATRE - CHEMISTRY
- C030 TEACHING & LEARNING CENTRE
- C031 DIXSON LIBRARY
- C032 DEMINERALISATION PLANT
- C033 T.C. LAMBLE BUILDING
- C034 INFORMATION TECHNOLOGY DIRECTORATE BUILDING
- C037 STUDENT ASSIST

NORTH

- N001 FLAMMABLE LIQUID STORE
- N002 MOTOR POOL
- N003 CENTRAL STORES
- N003A TEACHING & LEARNING DESPATCH
- N004 PRINTERY / BINDERY
- N005 FACILITIES MANAGEMENT SERVICES
- N006 GROUNDS OFFICE
- N007 WORKSHOP - AMENITIES BLOCK
- N008 FACILITIES MANAGEMENT SERVICES WORKSHOPS
- N008A FACILITIES MANAGEMENT SERVICES GLASS SHOP
- N009 SCIENCE AND ENGINEERING WORKSHOP
- N009A BOBCAT SHED
- N010 PUBLICATIONS OFFICE
- N011 ZOOLOGY ANNEXE
- N012 MAIN BOILER STATION
- N013 GROUNDS SHED
- N014 PROFESSIONAL DEVELOPMENT & LEADERSHIP
- N015 PROFESSIONAL DEVELOPMENT & LEADERSHIP
- N016 PROFESSIONAL DEVELOPMENT & LEADERSHIP
- N017 PROFESSIONAL DEVELOPMENT & LEADERSHIP
- N018 PROFESSIONAL DEVELOPMENT & LEADERSHIP
- N019 PROFESSIONAL DEVELOPMENT & LEADERSHIP
- N024 FACILITIES MANAGEMENT SERVICES EQUIPMENT STORE
- N025 WATER STORAGE TANK 1 - TOWN WATER SUPPLY
- N026 WATER STORAGE TANK 2 - TOWN WATER SUPPLY

BELLEVUE CAMPUS

- B016 WRIGHT CENTRE
- B021 WRIGHT COLLEGE - MASTERS RESIDENCE
- B022 ROBB COLLEGE - NORTH COURT (BLOCK 2)
- B023 ROBB COLLEGE - WEST COURT (BLOCK 3)
- B024 ROBB COLLEGE - DINING HALL (BLOCK 4)
- B025 ROBB COLLEGE - SOUTH COURT (BLOCK 1)
- B031 EARLE PAGE COLLEGE - MASTERS RESIDENCE
- B032 EARLE PAGE COLLEGE - DINING HALL
- B033 EARLE PAGE COLLEGE - BLOCK 1A
- B034 EARLE PAGE COLLEGE - BLOCK 2B
- B035 EARLE PAGE COLLEGE - BLOCK 3C
- B036 EARLE PAGE COLLEGE - BLOCK 4D
- B037 EARLE PAGE COLLEGE - MASTERS RESIDENCE
- B037 SPORTS PAVILION - BELLEVUE OVAL
- B041 AUSTIN COLLEGE - DINING HALL
- B042 AUSTIN COLLEGE - BLOCK A
- B043 AUSTIN COLLEGE - BLOCK B
- B044 AUSTIN COLLEGE - BLOCK C
- B051 DUVAL COLLEGE - BLOCKS A-F
- B052 DUVAL COLLEGE - BLOCKS G-L
- B053 DUVAL COLLEGE - DINING HALL & KITCHEN
- B061 WRIGHT VILLAGE - BLOCK A (FLATS 1 TO 8)
- B062 WRIGHT VILLAGE - BLOCK B (FLATS 9 TO 16)
- B063 WRIGHT VILLAGE - BLOCK C (FLATS 17 TO 24)
- B064 WRIGHT VILLAGE - BLOCK D (FLATS 25 TO 32)
- B065A WRIGHT VILLAGE - BLOCK A (FLATS 40 & 41)
- B065B WRIGHT VILLAGE - BLOCK B (FLATS 42 & 43)
- B065C WRIGHT VILLAGE - BLOCK C (FLATS 44 & 45)
- B065D WRIGHT VILLAGE - BLOCK D (FLATS 46 & 47)
- B065E WRIGHT VILLAGE - BLOCK E (FLATS 48 & 49)
- B065F WRIGHT VILLAGE - BLOCK F (FLATS 50 & 51)
- B065G WRIGHT VILLAGE - BLOCK G (FLATS 52 & 53)
- B065H WRIGHT VILLAGE - BLOCK H (FLATS 54 & 55)
- B066 STUDENT HEALTH CENTRE
- B070 ST. ALBERTS COLLEGE - ADMINISTRATION BLOCK
- B071 ST. ALBERTS COLLEGE - BLOCK A
- B072 ST. ALBERTS COLLEGE - BLOCK B
- B073 ST. ALBERTS COLLEGE - BLOCK C
- B074 ST. ALBERTS COLLEGE - BLOCK D
- B075 ST. ALBERTS COLLEGE - BLOCK E
- B081 DRUMMOND - SMITH COLLEGE - OFFICE & DINING HALL
- B082 DRUMMOND - SMITH COLLEGE - BLOCK 1A
- B083 DRUMMOND - SMITH COLLEGE - BLOCK 2B
- B084 DRUMMOND - SMITH COLLEGE - BLOCK 3C
- B085 DRUMMOND - SMITH COLLEGE - BLOCK 4D
- B087 BELLEVUE BOILER HOUSE
- B089 CREATIVE ARTS COTTAGE
- B092 UNE CONFERENCE COMPANY
- B100 UNE DIRECTORY BOARD
- B101 BUS SHELTER - ELM AVE EAST
- B102 BUS SHELTER - ELM AVE WEST
- B113 BELLEVUE OVAL RUGBY GRANDSTAND

SOUTH

- S001 ZOOLOGY
- S002 BOTANY
- S003 BIOLOGICAL SCIENCES - 1ST YEAR
- S004 BOTANY GLASSHOUSE - PSYCHOLOGY LANE
- S005 PSYCHOLOGY - HOWIE WING
- S006 PSYCHOLOGY - INCLUDES LECTURE THEATRE & WORKSHOP
- S007 PSYCHOLOGY NORTH WING
- S008 PSYCHOLOGY - CLINIC
- S009 BLACK ROSE
- S011 BOOLOOMINBAH
- S012 GARDENERS SHED
- S014 THE MOSQUE
- S029 HOCKEY AMENITIES
- S030 NEU COMPANY - UNIVERSITY REGIMENT
- S031 SPORT UNE - INDOOR SWIMMING POOL & WORSSELL ROOM
- S032 SPORT UNE - CAMPBELL HALL
- S033 SPORT UNE - SQUASH
- S034 PUMP HOUSE - LAKE ZOT
- S035 SPORT UNE - TENNIS SHED (CONSETT DAVIS)
- S037 BOTANY - SHADE HOUSE
- S038 FLOODLIGHT POLES (CONSETT DAVIS)
- S040 BOTANY - GLASSHOUSE CNR LIBRARY & TREVENNA ROAD
- S171 MARY WHITE COLLEGE - BLOCK 3
- S172 MARY WHITE COLLEGE - BLOCK 5
- S173 MARY WHITE COLLEGE - BLOCK 2
- S174 MARY WHITE COLLEGE - BLOCK 1
- S175 MARY WHITE COLLEGE - BLOCK 6
- S176 MARY WHITE COLLEGE - BLOCK 7
- S177 MARY WHITE COLLEGE - BLOCK 4
- S178 MARY WHITE COLLEGE - DINING HALL & KITCHEN
- S179 MARY WHITE COLLEGE - PRINCIPAL'S RESIDENCE

EAST

- E006 MILTON BUILDING
- E007 FACULTY OF EDUCATION, HEALTH & PROFESSIONAL STUDIES
- E008 MILTON ANNEXE
- E009 FIREMAN'S COTTAGE
- E010 CLEANING & CUSTODIAL SERVICES
- E011 ARTS, HUMANITIES & SOCIAL SCIENCE
- E012 ARTS THEATRE
- E015 FACILITIES MANAGEMENT SERVICES HERITAGE STORAGE
- E016 SUB-LODGE
- E017 OLD GROUNDS SHED
- E021 THE LODGE
- E022 OORALA CENTRE

WEST

- W001 VETERINARY HEALTH RESEARCH - MAIN OFFICE & LABS
- W002 ANIMAL HOUSE 'C'
- W003 ANIMAL HOUSE 'A' - SHEEP LAB
- W004 ANIMAL HOUSE 'B' - SMALL ANIMALS
- W006 NATURAL RESOURCES - LABORATORY STORE
- W009 FARM MECHANISATION LABORATORY
- W010 RADIOACTIVE WASTE STORE
- W010A ANIMAL HOUSE - STORAGE SHED
- W011 JSF BARKER
- W012 SHEEP PENS BUILDING
- W012A TRIPLE GARAGES
- W012B SEMEN COLLECTION SHED
- W015 ANIMAL SCIENCE - DROSOPHILA LABORATORY
- W016 ANIMAL SCIENCE - BEEF CATTLE UNIT
- W017 ANIMAL SCIENCE - TOMOGRAPHY BUILDING
- W021 NATURAL RESOURCES - WATER LABORATORY
- W022 AGRONOMY - SOIL LABORATORY
- W023 AGRONOMY
- W026 ANIMAL SCIENCE (OLD AGBU & MICROBIOLOGY)
- W028 PHYSIOLOGY
- W031 RURAL SCIENCE ANNEXE - WEST
- W032 RURAL SCIENCE ANNEXE - EAST
- W033 D.N.A. LABORATORY - ANIMAL CALORIMETRY BUILDING
- W034 MCCLYMONT BUILDING - RURAL SCIENCE
- W036 ST. MARKS ANGLICAN CHAPEL
- W037 AGRICULTURAL ECONOMICS - STAGE 1
- W038 AGRICULTURAL ECONOMICS - STAGE 2 & 3
- W039 ECONOMIC STUDIES - STAGE 1
- W040 ECONOMIC STUDIES - STAGE 2
- W041 A.B.R.I.
- W041A A.B.R.I. - P.C.D.E. BUILDING (PRIVATE PROPERTY)
- W042 ECONOMIC STUDIES - STAGE 3
- W043 TREVENNA
- W045 TREVENNA COTTAGE
- W046 LIVESTOCK INDUSTRY INSTITUTE - AGBU BUILDING
- W047 LIVESTOCK INDUSTRY INSTITUTE - HOMESTEAD
- W048 LIVESTOCK INDUSTRY INSTITUTE - MEAT SCIENCE LABORATORIES
- W049 LIVESTOCK INDUSTRY INSTITUTE - WOOLSHED
- W050 TREVENNA - GARAGE
- W051 TREVENNA - NURSERY
- W055 RESOURCE MANAGEMENT BUILDING
- W056 TREVENNA - BARN
- W058 FLAMMABLE LIQUID STORE NO.2
- W059 SHEARING SHED
- W060 TREVENNA - GARDENERS HUT
- W065 GREENHOUSE COMPLEX - POTTING SHED
- W066 GREENHOUSE COMPLEX - GREENHOUSE NO. 1
- W067 GREENHOUSE COMPLEX - GREENHOUSE NO. 1
- W068 GREENHOUSE COMPLEX - MECHANICAL PLANT ENCLOSURE
- W069 AGRONOMY STORAGE SHED

- UNIVERSITY ADMINISTRATION
- TEACHING & LEARNING CENTRE
- FACULTY OF ARTS & SCIENCES
- SAFETY & SECURITY
- FACULTY OF THE PROFESSIONS
- COLLEGES
- INFORMATION TECHNOLOGY
- SPORT UNE
- FACILITIES MANAGEMENT SERVICES
- NON-FACULTY BUILDINGS

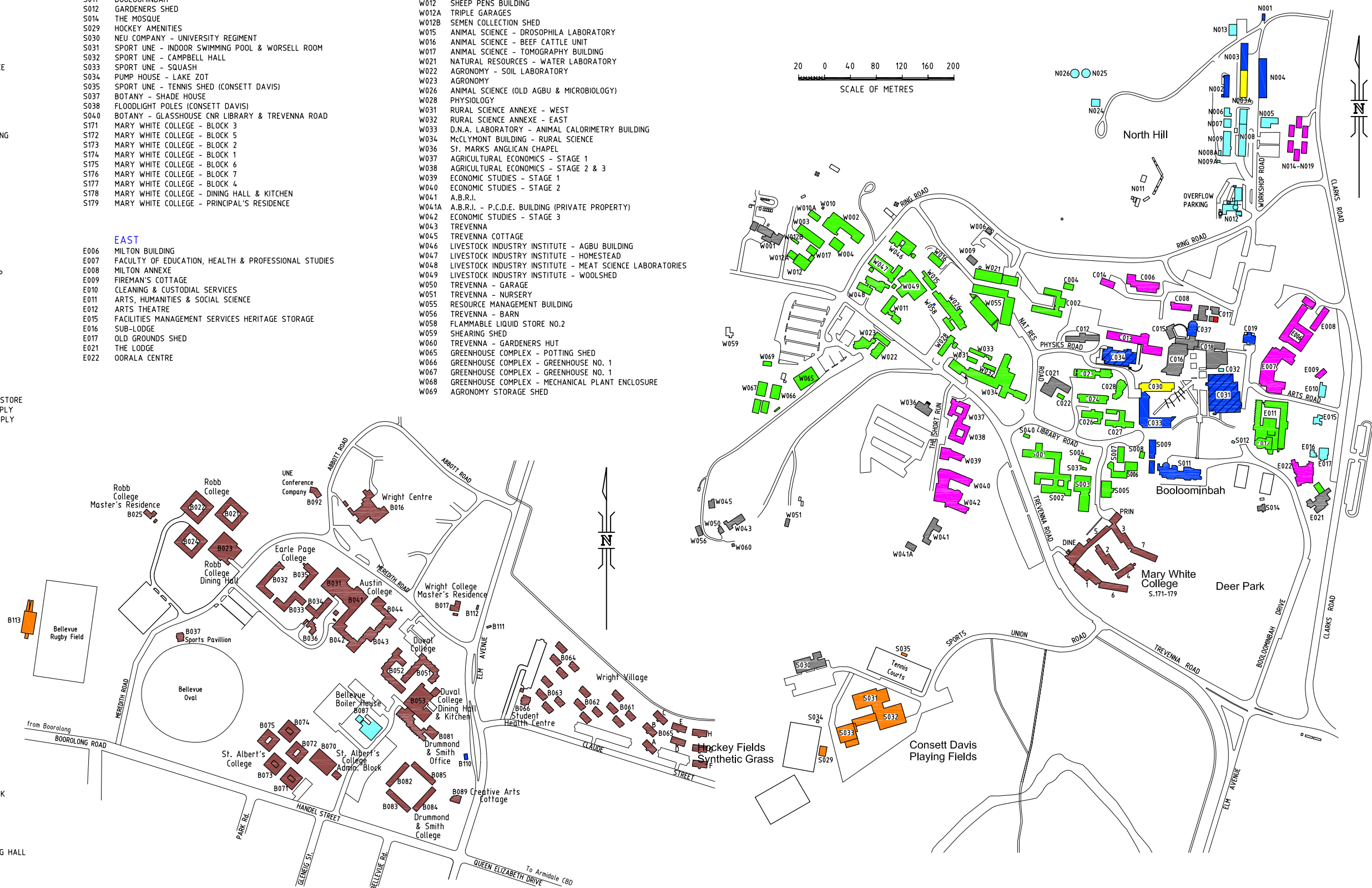

BELLEVUE CAMPUS

ACADEMIC CAMPUS